

Bulletin

The Official Publication of the Washington Building Congress | April / May 2017

Inside ▶

Industry Report.....	3
Craftsmanship Awards	9
Technology and Innovation	32
Member Projects	36
New Members.....	40
WBC Calendar.....	43



BEFORE YOU CAN GET TO WORK, WE HAVE TO FINISH OURS.



CLEAN EARTH WITH US.

Recycling over 3.6 million tons of material in 2016, Clean Earth continues to grow with over 25 years of experience treating and recycling contaminated soil for beneficial reuses, including construction fill and brownfield reclamation. It is our unique capability of providing a one-source, full-service solution to handle multiple waste streams from a single customer that separates us from the competition.



CLEAN EARTH.

Faster, smarter, greener solutions.®

877.445.DIRT | www.cleanearthinc.com

Bulletin

April/May 2017

Washington Building Congress is a nonprofit association made up of professionals from a variety of disciplines, all with an active interest or involvement in the Washington Metropolitan Area's real estate, design, and construction community. The organization was established in 1937 to represent the collective interests of its members by providing education and networking opportunities and by promoting the advancement of the building industry. For additional information about membership, joining a committee or the WBC Bulletin, call (202) 293-5922 or visit us on the web at www.wbcnet.org.

CHAIRMAN OF THE BOARD

Joe Schall, Pepco

CHAIRMAN-ELECT

Dan Buckley, Anchor Construction

VICE CHAIRMAN

Carl Hirrlinger, DAVIS Construction

VICE CHAIRMAN

Mike Baruccheri, Tishman Construction,
An AECOM Company

VICE CHAIRMAN

Brett Snyder, GreenBench Companies

TREASURER

W. Emerson Teer, Clark Construction Group, LLC

SECRETARY

Chuck Claar, Branch and Associates

IMMEDIATE PAST CHAIRMAN

John Barron, Tishman Construction,
An AECOM Company

DIRECTORS

Jacinda Collins, American Institute of Steel Construction

Julie Forsht, Powersmiths

Sean Frazier, HSU Builders

Bob Freas, Exponent

Bob Frew, Balfour Beatty Construction

Gabriel Jahn, Dynalectric Company

Greg Koger, Holland & Knight

Erin Meitzler, Forrester Construction

Patrick Mercer, Siemens Industry

PRESIDENT & CEO

Steven J. Kenton

ASSOCIATE DIRECTOR

Rita F. Reis

EDITOR/DESIGNER

Frost Miller Group

*Bulletin is published 10 times a year by Washington Building Congress, Inc. Individual subscriptions are available for \$139 per year. The articles in this publication are the opinions of the authors and do not necessarily represent or reflect the policies or opinions of Washington Building Congress.
Copyright 2017. All rights reserved.*

Washington Building Congress
1100 Vermont Avenue, NW, Suite 700
Washington, DC 20005
T: (202) 293-5922 | F: (202) 429-1922
www.wbcnet.org

CONNECT WITH US:



On the cover: MGM Grand National Harbor,
Oxon Hill, MD

Chairman's Letter

Dear Members and Colleagues:



Please take a moment to enjoy the 61st annual WBC Craftsmanship Awards special edition **Bulletin**. This year 83 winning entries were selected from the 255 excellent nominations received. Over 1,200 industry representatives gathered in March to recognize the work of over 400 individual craftsmen. We also inducted another Craftsman Hall of Fame class and announced the Star Awards winners. Over 10,000 men and women have won Craftsmanship Awards over the last 61 years and there are now 36 prominent members of the Hall of Fame. I want to thank everyone who supported this significant industry event, especially our outstanding craftsmen and sponsors. A complete list of current and past winners is available at wbcnet.org.

I also have some exciting news regarding the new Craftsman Hall of Fame exhibit at the WBC office. The emotion you feel at the awards banquet during the induction ceremony is now being conveyed with the amazing interactive video wall and display. The exhibit is in place and we are planning a fall grand opening event. All contributors over \$2,500 committed by August 1st will be prominently recognized on the Donor Wall in the Hall of Fame exhibit area. Further information regarding the Craftsman Hall of Fame fundraising campaign is available online. Please consider supporting this worthy initiative.

I would like to personally recognize the 2017 Craftsmanship Awards Committee, Chair Shawn Fenstermacher (Siemens Industry), Vice-Chair Todd Scales (Manhattan Construction), and Board Liaison Sean Frazier (HSU Builders) for an outstanding job. Thank you also to all of the judges and volunteers who help make this event run smoothly. The WBC Craftsmanship Awards and Hall of Fame continue to reach new levels each year and the 2017 program was another fitting tribute to our industry.

The Community Services Committee held the annual WBC Rebuilding Together Workday on April 29. 65 hardworking volunteers joined us for this hot day of giving back to those less fortunate in our community. The June-July **Bulletin** will highlight all of the individuals and companies involved with the project and feature some action photos from the workday. Special thanks go to House Captain Vanessa Carrion (Aerotek), Safety Coordinator Edward Dudlik (Morgan Stanley), and Trash Coordinator Jane Cherney (McCoy Associates). Thank you also to the Community Services Committee, Co-Chairs Ken Ellis (Langan) and Rob Wenger (WCS Construction), and Board Liaison Greg Koger (Holland & Knight).

The Membership Services Committee hosted the successful St. Patrick's member recruitment and networking event in March at McGinty's Public House. 35 people also attend the new member orientation breakfast at the WBC on April 7. Thank you to the Membership Services Committee, Chair Gary Cooke (Natelco Corporation), Vice-Chair Alfredo Llop (K2 Construction Consultants), and Board Liaison Erin Meitzler (Forrester Construction) for effectively focusing on our retention and new member goals this year.

Please mark your calendars for the 80th annual WBC Golf Outing on Monday, June 12, at Lansdowne and Belmont. Also take a moment to consider the sponsorship opportunities available for this great industry event, considered by many to be the premiere tournament of the year. Thank you to 2017 Tournament Sponsor Siemens Industry for their ongoing support. This is an excellent opportunity to showcase your business, entertain clients, and reward key employees. The 2017 Golf Outing Committee is co-chaired by Christine Heffernan (HESS Construction) and Chris Morse (Siemens Industry).

I look forward to seeing you at an upcoming WBC program or event. Thank you for your active participation and ongoing support of our great association!

Best regards,

Joe Schall

WBC Chairman of the Board

WBC Corporate Sponsor



An Exelon Company

↓
ABC 2016
Masonry Subcontractor
of the Year

↓
ABC 2016
Safety Training & Evaluation
Process Award, Gold Level

↓
WBC 2014
Craftsmanship
Award Winner

↓
ASA 2014
Carson V. Carlisle Jr.
Safety Award

HILTON HOMEWOOD SUITES
Arlington, Virginia

GENERAL CONTRACTOR:
DONOHOE CONSTRUCTION CO.

ARCHITECT:
GORDON & GREENBERG ARCHITECTS



Telligent
Masonry Construction

2273 Research Boulevard | Suite 550

Rockville, Maryland 20850

(301) 926-9600

T e l l i g e n t M a s o n r y . c o m

Skanska Expands Washington, DC Leadership Team



Darick Edmond



Alex Curlet

Skanska announced it has promoted **Darick Edmond** to vice president of operations and hired **Alex Curlet** as vice president/account manager in its Washington, DC office. In his new role, Edmond will directly oversee and manage all project teams in the DC region. Curlet will be responsible for the pursuit and execution of development

opportunities in the hospitality, office and multifamily sectors.

“Great projects require great leadership. Darick and Alex have the experience and temperament to motivate personnel and effectively communicate with clients,” said Steve Skinner, executive vice president and general manager of Skanska in Washington, DC. “Darick has been a tremendous asset to our team and has earned the trust of colleagues and clients alike. We welcome Alex with confidence that he will deliver superior projects with the highest level of performance and value.”

With more than 28 years of experience in the construction field, Edmond has amassed knowledge through hands-on engagement in building projects. He has worked in a variety of market sectors including residential, retail, mixed-use, education, federal, tenant fit-out and office based building projects. One of his most memorable projects was The Columbia, which involved converting a 1915 hospital into a luxury condominium.

Edmond graduated from Hampton University with a Bachelor of Science degree in building construction technology. He also served as a member of the United States Army Reserves, Corps of Engineers (retired Major).

Curlet comes to Skanska with ten years of operational and preconstruction

EDG ENGINEERING DESIGN GROUP

LEADERS → MEP Engineering for Building Industry

RELIABILITY
SUSTAINABILITY
AVAILABILITY

www.edg2.com

ISO 9001-2008 Certified

BUILDING WASHINGTON FOR OVER A CENTURY

CLARK
CONSTRUCTION

What's under our **hard hat?**

COMMERCIAL OFFICE RENOVATION

GRUNLEY

experience. Prior to joining Skanska, he was with the Clark Construction Group where he worked in the field and the preconstruction department. Most recently he oversaw conceptual, schematic and design development budgets for office, hospitality and multifamily projects.

Curlet received a Bachelor of Science degree from Washington and Lee University and a Master of Business Administration degree from Goizueta School of Business at Emory University. He serves as the treasurer and an executive committee member of First Tee of Washington, which teaches life skills to young people through the game of golf.

HITT Contracting's Multifamily Team Kicks Off Initiative to Plant a Tree for Every Apartment Unit Built

HITT Contracting's Multifamily team recently launched their Trees for Keys initiative, which aims to plant a tree for every individual unit they complete in a multifamily building. To kick off the project, the team came together on Earth Day with Casey Trees to plant trees along DC's Suitland Parkway.

Currently the team has 2,050 apartments under construction. In addition to planting trees for these units, the team will also plant trees for all future units turned over. They are working retroactively too, planting 1,219 trees through a partnership with the National Forest Foundation for units previously completed.

"Every key that unlocks one of the new apartment units we've built also unlocks a greener future for the planet," said Josh Foreso, Vice President of HITT's base building sector, who oversees the company's multifamily work and developed this initiative. "Our team recognizes that our resources are finite, and we're proud to be able to give back in this way."

"This is a natural extension of our Community Contribution and Environmental Sustainability efforts—both pillars of our Corporate Responsibility plan," said Katie Rothenberg, director of

THE PRACTICE OF SOLUTIONS

Construction | Government Contracts
Real Estate Transactions

Ranked by **Chambers USA** as one of the leading Construction law firms in Washington, DC



5335 Wisconsin Avenue, NW Suite 400
Washington, DC 20015
202-244-4264 ♦ www.asm-law.com

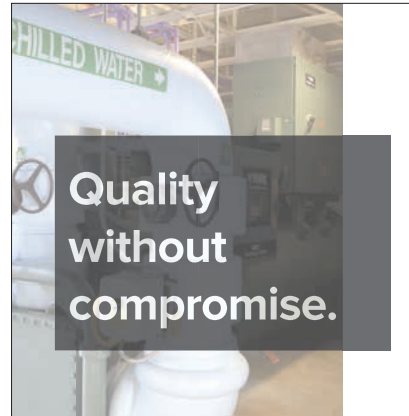

Quality
without
compromise.

Award winning mechanical contractor serving the Washington DC area for over 80 years.

RM THORNTON
MECHANICAL
A DIVISION OF HARRIS COMPANIES

120 Westhampton Ave.
Capitol Heights, MD 20743
301-350-5000 | rmthornton.com



KEEP BUILDING PARTNERSHIPS.

Our subcontractors' qualifications, skill and commitment are key to Forester's success. That's why building solid, long-term partnerships is so important to us. Forester's subcontractor partners know they can rely on our teams and we know they will deliver quality results.

www.foresterconstruction.com/subcontractors



sustainable construction and corporate responsibility. “We strive to be a leader in building sustainably, and are grateful for the opportunity to promote green practices in our communities as well.”

The company’s recently completed multifamily projects include The Related Companies’ One Hill South, The JBG Companies’ Atlantic Plumbing, Quadrangle Development Corp’s Lyric Apartments, and both the WestBroad Residences in the City of Falls Church and Prosperity Flats in the growing Merrifield area. They are currently engaged on JBG’s West Half project, Quadrangle’s Lydian at 400 K Street, and PN Hoffman’s 680 Eye Street job.

Balfour Beatty US Names Kreis Mid-Atlantic Vice President of Business Development

Balfour Beatty US has named **George Kreis** as vice president of business development and a member of its leadership team in the Mid-Atlantic. Kreis has more than 30 years of experience in the construction industry and his portfolio includes \$2 billion of construction work in the Mid-Atlantic region. Notable projects include the National World War II Memorial and the Gaylord National Resort & Convention Center.

Kreis joins Balfour Beatty from Manhattan Construction Company, where he served as senior vice president and division manager for its Mid-Atlantic division. He has worked with other major construction companies in the Mid-Atlantic region throughout his career, developing new business opportunities, driving leads and diversifying project portfolios.

Kreis earned his BS in civil engineering from Bucknell University. He has served on the board of numerous local professional associations, including Washington Building Congress, Associated Builders and Contractors of Metro Washington, DC Building Industry Association, and Associated General Contractors of Metropolitan DC.



YOU MAY NOT SEE US AND WE’RE OKAY WITH THAT.

In fact, we take pride in it.

At Black & Veatch we work with our clients to design, build and operate the things that deliver the energy, water and communications services you use every day.

Visit bv.com/you to learn more.



Committed to Excellence



6305 IVY LANE
SUITE 800
GREENBELT, MD 20770
301.656.7800

INTEGRITY | EXCELLENCE | EXPERIENCE | LEADERSHIP

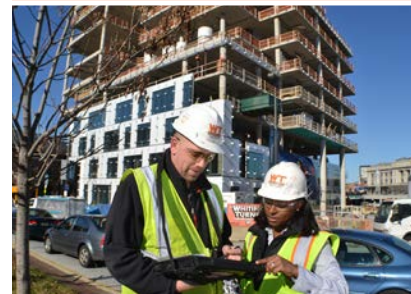

RESULTS FIRST™

Peckar & Abramson, P.C.

COUNSEL TO THE CONSTRUCTION INDUSTRY

2055 L STREET, N.W.
WASHINGTON, D.C. 20036
202.293.8815

NEW YORK, NY • RIVER EDGE, NJ • MIAMI, FL • WASHINGTON, D.C. • LOS ANGELES, CA
OAKLAND, CA • CHICAGO, IL • AUSTIN, TX • DALLAS, TX • HOUSTON, TX • DEVON, PA

WWW.PECKLAW.COM

Jones Named Fox's Washington, DC Office Managing Partner



Reggie Jones

Fox Rothschild is pleased to announce that **Reggie Jones** has been appointed managing partner of the firm's Washington, DC office. In this role, he will oversee and manage the

day-to-day operations and finances while playing a key role in enhancing client service for Fox, one of the nation's oldest and largest law firms according to *The Am Law 100* and *The National Law Journal*.

As chair of the firm's Federal Government Contracts and Procurement Practice Group, Jones has a well-established federal litigation and compliance practice with a focus on complex claims prosecution and defense, litigation and alternative dispute resolution. He will also continue his

commercial construction litigation practice. His clients include national and international corporations, including private developers, REITs, defense contractors, design and engineering firms, construction managers and large specialty trade contractors.

DAVIS Safety Program Leads Region With Fall Rescue System

With the introduction of Checkmate descent and rescue systems, DAVIS is the first general contractor in the Washington, DC region to have state-of-the-art fall rescue equipment onsite for safe retrieval of someone in the event of a fall.

Even with strict safety measures in place, the risk for a fall still exists in some jobsite areas. Any employee working alongside an unprotected side or edge more than six feet above a lower level must use a form of fall protection, such as a retractable lifeline. A lifeline

locks at a speed of 4-1/2 feet per second – much like a seatbelt – leaving a fall victim suspended in their safety harness. To prevent harness suspension trauma or life-threatening injuries, such as loss of circulation, a fall victim must be rescued within 15 minutes. After testing several fall rescue systems, the DAVIS safety team determined that the Checkmate Max 300R was the only one that met the company's high safety standards. Using the equipment during all mock-rescues, teams successfully returned fall victims to safety in less than five minutes. As a DAVIS best practice, suspension trauma straps are standard issue to all employees. The straps are used by temporarily placing legs in the strap to relieve pressure from the harness, allowing for additional rescue time if needed.

To use the system, a rescue line is attached to a fall victim's harness. If a fall victim is unable to attach the line themselves, then a telescoping pole is used. Once attached, the system's hand



CREATING AND ENHANCING VALUE
FOR MORE THAN 50 YEARS



JBG.COM

wheel and gear box allows a person of any size to lower or raise a fall victim to safety. The system is intuitively designed to lower a fall victim at four feet per second, to avoid the lifeline from locking in place. Ideally, they would be brought to the nearest grade or level, but in the case that a longer descent is necessary, our systems include 300 feet of rescue line for our tallest projects.

Under the leadership of DAVIS Safety Director, Dave Chandler, ten in-house safety managers + OSHA-30 instructors provide hands-on fall rescue training to project teams. All Checkmate systems are centrally located onsite, with numerous DAVIS employees trained in how to properly deploy and operate them in the event of a fall. **B**



FOULGER-PRATT
We Build to Last | foulgerpratt.com
240.499.9600



ROSENDIN ELECTRIC

DATA CENTERS. BIOTECH/
PHARMA. HEALTHCARE.
COMMERCIAL. HIGH
TECH. RENEWABLE
ENERGY. EDUCATION.
HOTELS. INSTITUTIONAL.
TRANSPORTATION.

WWW.ROSENDIN.COM



FOOD & FRIENDS®

219 Riggs Rd., NE
Washington, DC

Help prepare and package, meals for and delivers meals and groceries to more than 1,400 people living with HIV/AIDS, cancer and other life-challenging illnesses throughout the Washington area.

Please register directly through Food & Friends at foodandfriends.org

BUILT FOR Washington, DC



HENSEL PHELPS
Plan. Build. Manage.



BUILT to SUCCEED



COHEN SEGLIAS
PALLAS GREENHALL & FURMAN PC
Attorneys at Law

1828 L Street, NW
Suite 705
Washington, DC 20036
202.466.4110

www.cohenseglias.com
www.constructionlawsignal.com
www.fedconblog.com
www.investigationslawblog.com

PENNSYLVANIA NEW JERSEY NEW YORK DELAWARE MARYLAND WASHINGTON, DC KENTUCKY



THE ENERGY BEHIND YOUR POWER.

We're proud to support the Washington Building Congress,
and to provide safe, reliable energy to more than 842,000
customers in the District of Columbia and Maryland.



An Exelon Company



2017 Annual WBC Craftsmanship Awards

*Special Construction:
Water Feature
National Museum
of African American
History and Culture,
Washington, DC*

Outstanding Craftspeople Honored by DC's Building Industry

On March 31st, more than 1,200 individuals from all aspects of the Washington Metropolitan area's building industry gathered to recognize DC's top craftsmen and women at the Washington Building Congress' 61st Annual Craftsmanship Awards banquet and ceremony. More than 12,000 individuals have been honored over the past 61 years for their craftsmanship on over 3,100 winning projects.

"The Washington Building Congress takes great pride in quality craftsmanship, and recognizing individual craftsmen," said Joe Schall, WBC's 79th Chairman of the Board. "[The Craftsmanship Awards] is the only regional program recognizing the individual contributions of craftsmen working on jobsites every day."

In addition to the traditional awards which have been given since the inaugural awards program in 1956, up to five deserving craftsmen may be nominated by the WBC Craftsmanship Awards Committee and approved by the WBC Board of Directors to be inducted in the Craftsman Hall of Fame. There are currently 36 members of the Hall of Fame.

"I am pleased to announce that this year we are inducting the 10th group of craftsmen into the WBC Craftsman Hall of Fame," said Schall. "The Hall of Fame provides an excellent means

to individually recognize the best of the best in our industry."

Selection of the Hall of Fame inductees is based on the number of awards an individual has received, the individual's time in the building industry, and other factors that may be relevant.

The night's three 2017 Hall of Fame inductees were:

- **Fernando Barbosa – Masonry**
- **James Quine – Mechanical**
- **Mark Valentine – Special Construction**

During the evening, Schall and WBC Chairman-Elect Dan Buckley gave an update on the Craftsman Hall of Fame exhibit coming to WBC's headquarters. Designed to honor the members of the Craftsman Hall of Fame, construction of the exhibit is underway with the grand opening coming this spring.



2017 Star Award Winners

“To sustain this noble cause we need your support,” explained Buckley. “We have raised over half of the goal for the Hall of Fame exhibit for the next eight years. Please consider supporting this initiative.”

This year, WBC received 255 nominations in 10 trade categories from site work to finishes. With the participation and support of 155 volunteer judges, 33 teams of evaluators went out in early January to evaluate all of the nominated projects. The evaluations were compiled, results tallied, and 83 winning entries were identified based upon the judges’ scoring. (A complete listing of the winning projects follows, and a complete list with project descriptions is available online at www.wbcnet.org.)

Very few companies had winning craftsmen on more than one or two projects, however craftsmen from **JE Richards Electric, Inc.** were awarded for eight projects and craftsman from **Clark Concrete, LLC, Clark Foundations, Inc., Mona Electric Group, Inc., Rugo Stone, LLC, and Singleton Electric Company, Inc.** each received praise on three projects.

Clark Construction Group, LLC was general contractor on 18 projects (including projects completed by **Clark/Smoot/Russell, A Joint Venture, Clark/Parsons, A Joint Venture, and Clark/Christman, A Joint Venture**); **The Whiting-Turner Contracting Company** was general contractor on 13 projects; and **DAVIS Construction** was general contractor on nine projects.

Following the selection of the award winners, a separate group of Star Award evaluators representing different industry perspectives and disciplines independently evaluated the Star Award nominees. Eight outstanding entries were recommended for this distinction for demonstrating the highest level of quality and exceeding the awards criteria to achieve a level defined as “Exceptional.” From these, the Star Award winners for Visual Excellence, Technical Excellence and Excellence in the Face of Adversity were selected.

“Star Award winning craftsmen encompass the key characteristics of all Craftsmanship Award winners and exhibit the highest level of focus on the essence of excellence,” said 2017 Craftsmanship Awards Chair Shawn Fenstermacher of Siemens Industry.

This year, the Star Award for Excellence in the Face of Adversity was awarded to the team of **Johnathan Castro, Julian Davis, Amadeo Gonzales, Roger Marquez, Jose Romero** and **Marlon Salmeron** with **Hayles and Howe, Inc.** for **Plaster** at **Union Station**.

Hunter Dunn, Mark Dunn, Tony Franklin, Adam Pashkevich, Chris Pashkevich and **Thomas Snowden** with **Clark Foundations, LLC** were honored with the Star Award for Technical Excellence for **Underpinning, Foundations and Excavations** at **655 New York Avenue**.

Finally, the Star Award for Visual Excellence was presented to **Jose Ambriz, Walter Blair, David Burkhardt, Marcus Butler, Rolando Hernandez** and **Frank Orren** with **Arban & Carosi, Inc.** for **Precast Concrete** at **MGM National Harbor**.

Congratulations to all of the evening’s winners!



Winners for Excellence in the Face of Adversity
Union Station

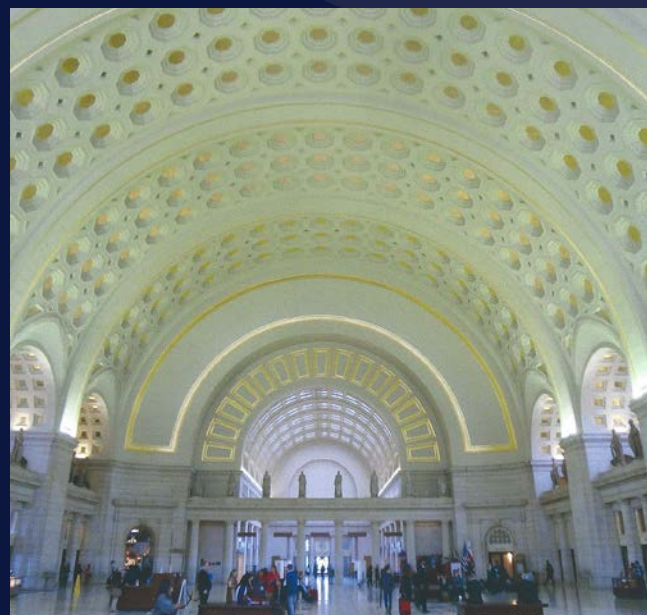

★ 2017 Star Award Winners

2017 CRAFTSMANSHIP AWARDS



Winners for Visual Excellence
MGM National Harbor



Winners for Technical Excellence
655 New York Avenue



Following are the names of all the Craftsmanship Award winners along with the projects on which they worked, their employers, and where applicable, the general contractors and other key project team members. Star awards are marked with a ★.

2017 CRAFTSMANSHIP AWARDS



CONCRETE

CAST-IN-PLACE CONCRETE

Bernabe Diaz, Jose Majano-Cruz, Jose Monroy, Pablo Ocampo, Russel Reeder, Mauricio Villanueva
— *Clark Concrete, LLC*

Project: West End Square 37 - Washington, DC
Architect: WDG Architecture, PLLC
Engineer: Tadjer Cohen Edelson Associates
General Contractor: Clark Construction Group, LLC

Jesus Amaya, Leon Hann, Eric Lopez, Manuel Ramos Perez, Jay Schnarrs, Jose Trejo — *Miller & Long Co., Inc.*

Project: Reston Station Office Building 1 - Reston, VA
Architect: JAHN
Engineer: Thornton Tomasetti
General Contractor: DAVIS Construction

Jose Benitez, Luis Chicas, Matias Garcia, Oman Eslava Garcia, James Jeffries, Placido Majano — *Clark Concrete, LLC*

Project: CSX Virginia Avenue Tunnel
Reconstruction Project - Washington, DC
Architect: Parsons Transportation Group
Engineer: Parsons Transportation Group
General Contractor: Clark/Parsons, a Joint Venture

Jose D. Cedillos, Jose R. Martinez, Eduardo A. Mejia, Jose S. Reyes, William Sewell, Michael D. Wines
— *Miller & Long DC, Inc.*

Project: The Wharf - Phase I - Washington, DC
Architect: Perkins Eastman DC
Engineer: SK&A / Thornton Tomasetti, Joint Venture
General Contractor: Clark Construction Group, LLC

Keith Fultz, Angel Lopez, Francisco Martinez, Victor Melendez, Elmer Rivera, Jose Villanueva
— *Miller & Long Co., Inc.*

Project: The Adaire - Vienna, VA
Architect: R2L Architects
Engineer: SK&A MD
General Contractor: John Moriarty & Associates of VA, LLC



Concrete: Cast-in-place Concrete
Reston Station Office Building 1, Reston, VA

PRECAST CONCRETE

★ **Jose Ambriz, Walter Blair, David Burkhardt, Marcus Butler, Rolando Hernandez, Frank Orren**
— *Arban & Carosi, Inc.*

Project: MGM National Harbor - Oxon Hill, MD
Architect: SmithGroupJJR
Engineer: Cagley & Associates, Inc.
General Contractor: The Whiting-Turner Contracting Company



SPECIAL CONCRETE FINISHES

Leonides Avezalo, Manuel Ayala, Juan Lazo, Tyrone Lucas, Valerio Meldonado-Gomez, Jose Valle Pena
— *Clark Concrete, LLC*

Project: University of Maryland A. James
Clark Hall - College Park, MD

Architect: Ballinger

General Contractor: Clark Construction Group, LLC



DOORS & WINDOWS

EXTERIOR GLASS

★ **Roger Compton, Charles Mills, Carlos Quinteros, John Salguero, Joseph Shifflet, Joshua Tyeryar**
— *Custom Glass Services, Inc.*

Project: Museum of the Bible - Washington, DC

Architect: SmithGroupJJR

Engineer: Tadjer Cohen Edelson Associates

General Contractor: Clark Construction Group, LLC

Jaime Diaz, Mario Escobar Jr., Juan Navarro, Meesac Ruiz, Raymond Smith, Douglas Soriano — *The Craftsmen Group, Inc.*

Project: Trump International Hotel at the

Old Post Office - Washington, DC

Architect: WDG Architecture, PLLC

Engineer: Robert Silman Associates

General Contractor: Lendlease (US) Construction, Inc.

INTERIOR GLASS

Jerry Burch, David Moore, Preston Penn, Vince Penn, Jim Rathbone, John Thurman
— *UGC/Kensington Glass Arts, Inc.*

Project: National Museum of African American
History and Culture - Washington, DC

Architects: Adjaye Associates/Davis Brody
Bond/Freelon/SmithGroup JJR

Structural Engineers: Guy Nordenson and
Associates/Robert Silman Associates

General Contractor: Clark/Smoot/Russell, a Joint Venture

Nicholas Brunetti, Elena Da Re, Nick Kozer
— *Modulo 3 Corporation d/b/a Unifor*

Project: Bracewell - Washington, DC

Architect: Gensler

General Contractor: Harvey-Cleary Builders

SPECIALTY FEATURES

Bob Beard, Anthony Drew, Jeff Farley, Elwood Gant, Tom Mulligan, Jim Strobel Sr.

— *Super Sky Products Enterprises, LLC*

Project: Trump International Hotel at the
Old Post Office - Washington, DC

Architect: WDG Architecture, PLLC

Engineer: Robert Silman Associates

General Contractor: Lendlease (US) Construction, Inc.



*Doors & Windows: Exterior Glass
Museum of the Bible, Washington, DC*

Brian Ashcraft, Cody Kesler, Kevin Link, Peter Montanino, Mark Sanford, Casey Smith — *Transwall Office Systems, Inc.*

Project: MITRE 4 - McLean, VA

Architect: SKA Studio

Engineer: Dewberry Engineers, Inc.

General Contractor: The Whiting-
Turner Contracting Company

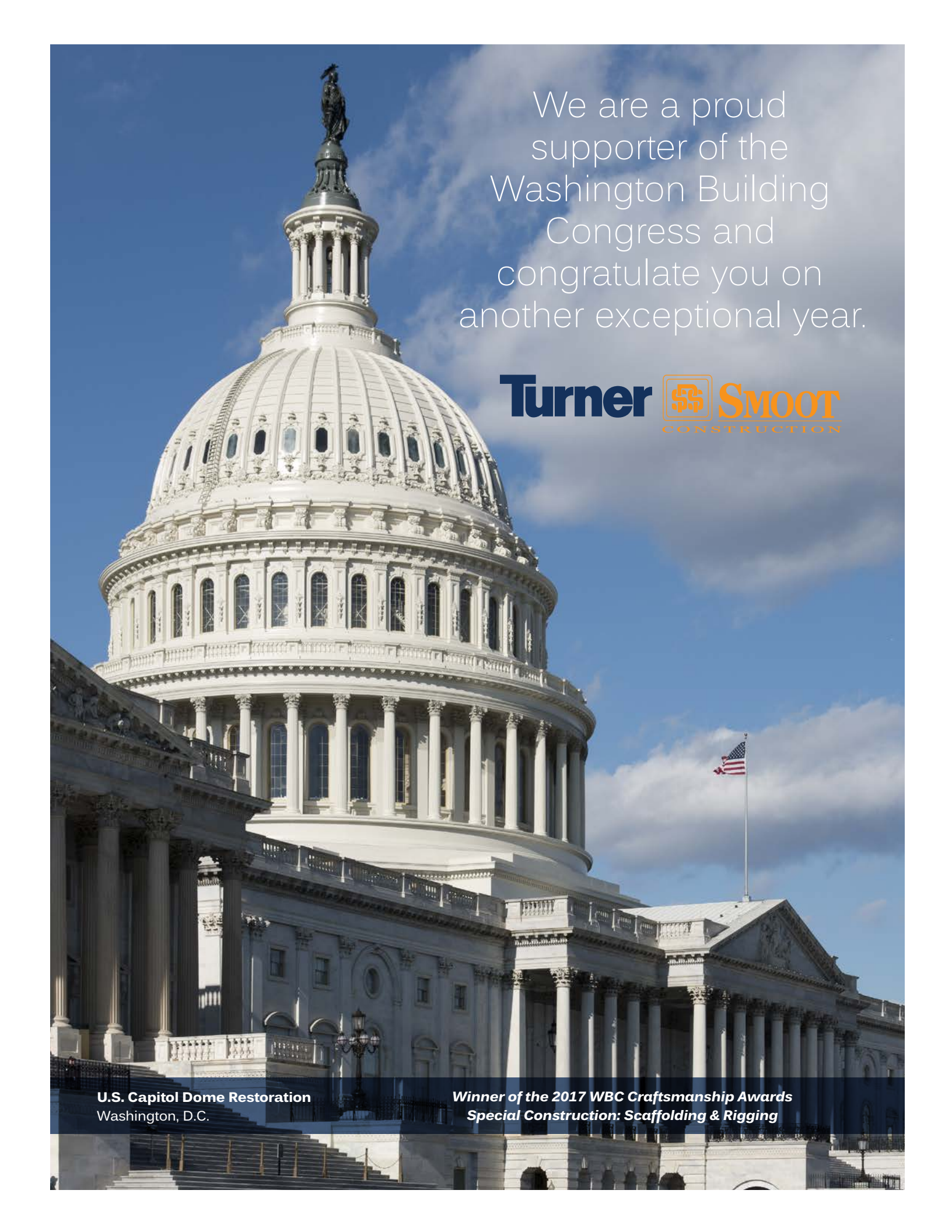
A photograph of the U.S. Capitol building in Washington, D.C., showing the large white dome and the surrounding classical architecture. The sky is blue with some clouds. An American flag is visible on a tall pole to the right of the dome.

We are a proud supporter of the Washington Building Congress and congratulate you on another exceptional year.

Turner  **SMOOT**
CONSTRUCTION

U.S. Capitol Dome Restoration
Washington, D.C.

Winner of the 2017 WBC Craftsmanship Awards
Special Construction: Scaffolding & Rigging



ELECTRICAL

LIGHTING SYSTEMS

Leo P. Cook, Jr., William Despres, Cristian Bonilla Garcia, John Grambo, Ryan Kruckow, Brian Sutton
— *JE Richards Electric, Inc.*

Project: MGM National Harbor Hotel - Oxon Hill, MD
Architect/Engineer: SmithGroupJJR
General Contractor: The Whiting-Turner Contracting Company

Cody Blair, Kris Hamilton, Scott Stone
— *Aarow Electrical Solutions*

Project: National Museum of the Marine Corps
Lighting Replacement Phase I - Triangle, VA
Architect: Aarow Electrical Solutions

Dave Amador — *Construction Helicopters, Inc.*
and **Eric Harbour, Gerry Knight, Landon Milstead, Chris Schiro, Clinton Simpson**
— *Singleton Electric Company, Inc.*

Project: Secondary Treatment Facility Upgrades Enhanced
Nitrogen Removal - North - Washington, DC
Architect: Black & Veatch
Engineer: Shah & Associates
General Contractor: Ulliman Schutte Construction, LLC



*Electrical: Lighting Systems
Bracewell and Giuliani, Washington, DC*

Corey Beach, Timothy Harrigan, Kenneth Newton, John Pedrazas, Victor Lazarte Pena, Wilber Villeda
— *JE Richards Electric, Inc.*

Project: MGM National Harbor Theatre - Oxon Hill, MD
Architect/Engineer: SmithGroupJJR
General Contractor: The Whiting-Turner Contracting Company

Bruce Clodfelter, Chad Jenkins, Troy Marshall, Brett Roper, Jose Sanabria, Matthew Wells — *Dynalectric Company*

Project: Sands Capital Management - Arlington, VA
Architect: OTJ Architects
Engineer: GPI Greenman-Pedersen, Inc.
General Contractor: DAVIS Construction

John Carey, Ben Davis, Hans Grahek, Richard Lee, John Martin, Mike Mulligan
— *Freestate Electrical Construction Company*

Project: Trump International Hotel at the
Old Post Office - Washington, DC
Architect: WDG Architecture, PLLC
Engineer: Robert Silman Associates
General Contractor: Lendlease (US) Construction, Inc.

Bill Eaton, Dave Nicholson, Jarrett Randall, Mike Robinson, Tom Shannon, Don White
— *Singleton Electric Company, Inc.*

Project: International Monetary Fund Headquarters
Renovation Sequence 1 - Washington, DC
Architect: Skidmore, Owings & Merrill, LLP
Engineer: WSP Flack & Kurtz
General Contractor: Grunley Construction Company

Daniel Breece, Michael Breece, Eric Cullens, Joseph Morgan, Mohamed Oubalhaj, Michael Shipyan
— *JE Richards Electric, Inc.*

Project: Bracewell and Giuliani - Washington, DC
Architect: Gensler
Engineer: GHT Limited
General Contractor: Harvey-Cleary Builders

Jason Murvin, Jeff Pawlak, Thomas St. John
— *Mona Electric Group, Inc.*

Project: 1789 Massachusetts Avenue NW
Renovation - Washington, DC
Architect: Hartman-Cox Architects
Engineer: Robert Silman Associates
General Contractor: Grunley Construction Company

CELEBRATING **50** YEARS
Mona
Electric Group, Inc.

Your Single Source for Integrated Electrical Solutions

2017 WBC Craftsmanship

**National Museum of African
American History and Culture**

*Fire Alarm
& Exhibit Work*

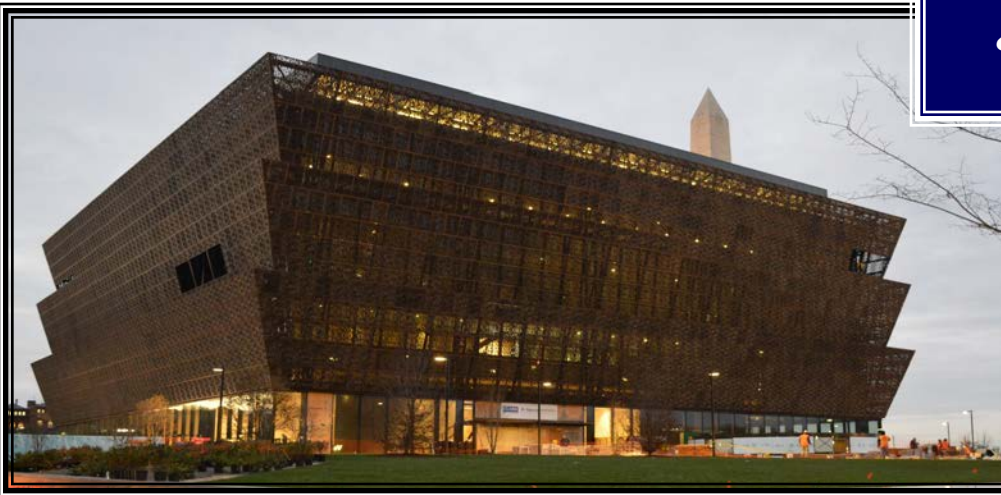

**1789 Massachusetts Avenue NW
Renovation**



Lighting

Serving the DC Metropolitan Area Since 1966

MONA ELECTRIC Is Proud to be a
53 Time Recipient of
WBC Craftsmanship Awards

7915 Malcolm Road * Clinton * MD * 20735

301-868-8400 * 1-800-GET-MONA * www.GETMONA.com



Yaw Awuah, John Canterbury, Allan Harrison, Bobby Knauss, Rob Martin

— *VarcoMac Electrical Construction Co.*

Project: Office Tenant Fitout – Undisclosed
Client - Arlington, VA
Architect: Architecture Inc.
Engineer: Built Environment Engineers
General Contractor: DPR Construction

Donnie Beach, Santos Hernandez, Jason Ketchel, Lazar Koytchev, Allan Potts, Usher Tanveer

— *Rosendin Electric, Inc.*

Project: MGM National Harbor - Casino - Oxon Hill, MD
Architect/Engineer: SmithGroupJJR
General Contractor: The Whiting-Turner Contracting Company

Alexander Marion, Richard Rodriguez, Rafael Rosa, Juan Ruiz, Nicholas Sames, Ryan Seal

— *JE Richards Electric, Inc.*

Project: U.S. Diplomacy Center - Washington, DC
Architect: Beyer Blinder Belle
Engineer: Vanderweil Engineers
General Contractor: Gilbane Building Company

POWER GENERATION, DISTRIBUTION AND SWITCHGEAR

Tom Crown, Joe Fuentes, Chris Lawshe, Mark R. Miller, Nick Thompson, Daniel Vallandingham

— *Dynalectric Company*

Project: Sabey Data Center Building C - Ashburn, VA
Architect/Engineer: Lane Coubern Associates
General Contractor: Sabey

Corey Beach, Justin Davis, Hector Guzman, Marty O'Neil, Chouaibou Pafouyouom, Isaiah Simmons

— *JE Richards Electric, Inc.*

Project: MGM National Harbor Theatre - Oxon Hill, MD
Architect/Engineer: SmithGroupJJR
General Contractor: The Whiting-Turner Contracting Company

Daniel Groht, Charles Johnson, Shaun Mooney, James K. O'Donnell, Andrew Rozewicz, Benjamin Vess

— *JE Richards Electric, Inc.*

Project: MGM National Harbor, Central Utility Plant - Oxon Hill, MD
Architect/Engineer: SmithGroupJJR
General Contractor: The Whiting-Turner Contracting Company

Robert Davis, Eric Figueroa, Juan Guillen, Terry Scott Metzgar, Ray Murphy, James Slattery, Jr.

— *JE Richards Electric, Inc.*

Project: Providence Power Upgrade - Washington, DC
Engineer: TME Engineering
General Contractor: JE Richards, Inc.

SPECIAL SYSTEMS

Steve Delaney, Ali Lindsey, Bill Reed, Mike Vanduzer, Richard Yuracka

— *Mona Electric Group, Inc.*

Project: National Museum of African American History and Culture - Fire Alarm - Washington, DC
Architects: Adjaye Associates/Davis Brody Bond/Freelon/SmithGroup JJR
Engineer: WSP Flack & Kurtz
General Contractor: Clark/Smoot/Russell, a Joint Venture

Eric Harbour, Mike Kern, Emerson Rodriguez, Freddy Rodriguez, Ron Washabaugh, Mike Youmans

— *Singleton Electric Company, Inc.*

Project: Secondary Treatment Facility Upgrades Enhanced Nitrogen Removal - North - Washington, DC
Architect: Black & Veatch
Engineer: Shah & Associates
General Contractor: Ulliman Schutte Construction, LLC

Taurus Carroll, Shane Galloway, Marty Lang, Zachary Raines, Robert C. Russell, Shawn Sperry

— *JE Richards Electric, Inc.*

Project: MGM National Harbor Fire Alarm - Oxon Hill, MD
Architect/Engineer: SmithGroupJJR
General Contractor: The Whiting-Turner Contracting Company

Ramchand Deonarine, Randy Donahue, Mark Fuhrmann, Matthew Grady, Rick Lee, Charles Williams

— *Mona Electric Group, Inc.*

Project: National Museum of African American History and Culture - Exhibits - Washington, DC
Architect: Ralph Appelbaum Associates, Inc.
Engineer: WSP Flack & Kurtz
General Contractor: Design and Production Company



Installation view of Alexander Calder: A Survey in East Building, Tower 2 galleries. Copyright © 2016 Calder Foundation, New York/Artists Rights Society (ARS), New York. Photo by Rob Shelley. Photo Copyright © 2016 Board of Trustees, National Gallery of Art, Washington



FINISHES

DRYWALL

Fredy Claire, Johnny Esquivel, Raul Ferrufino, Martin Marin, Edgar Olivera, Jose G. Reyes

— *Tricon Construction, Inc.*

Project: John R. Thompson Jr. Intercollegiate Athletic Center - Washington, DC

Architects: Bowie Bridley Architects/Populous

General Contractor: The Whiting-Turner Contracting Company

FLOORING

Patrick Joy, Colin Wintermeyer — *Master Care Flooring, Inc.*

Project: The National Gallery of Art - Washington, DC

Architect: Hartman-Cox Architects

General Contractor: The Whiting-Turner Contracting Company

PLASTER

Ivaylo Borisov, Sonny Lechoco, Maribel Loza Rodriguez, Meliton Soto, Yuce Cesar Soto, Elmer Zurita

— *ATS Studios, LLC*

Project: National Museum of Natural History Renovation - Halls 2 & 6 - Washington, DC

Architect: EwingCole

General Contractor: Grunley Construction Company

Windsor Arebalo, Carlos Escobar, Moises Hernandez, Jorge Quezada, Orlando Rivera, Zandro Villarroel — *C.J. Coakley Co., Inc.*

Project: 1789 Massachusetts Avenue NW Renovation - Washington, DC

Architect: Hartman-Cox Architects

Engineer: Robert Silman Associates

General Contractor: Grunley Construction Company



Photography of the new Roof Terrace of The National Gallery of Art East Building. Several sculptures are on view, including Hahn/Cock (2013) by German artist Katharina Fritsch, on long-term loan from Glenstone Museum, Potomac, Maryland. © Artists Rights Society (ARS), New York/VG Bild-Kunst, Bonn. Photo by Rob Shelley © 2016 Board of Trustees, National Gallery of Art, Washington

★ **Johnathan Castro, Julian Davis, Amadeo Gonzales, Roger Marquez, Jose Romero, Marlon Salmeron**
— *Hayles and Howe, Inc.*

Project: Union Station - Washington, DC
Architects: Gensler/John Bowie Associates
Engineer: McMullan & Associates, Inc.
Construction Manager: Jones Lang LaSalle

Christian Huatay, Ivo Koytechv, Christian Pardo, Yuce Cesar Soto, Vladimir Tapia, Anna Torre-Smith — *ATS Studios, LLC*

Project: The Watergate Hotel - Washington, DC
Architect: Ron Arad
General Contractor: Grunley Construction Company



MASONRY

EXTERIOR STONE

Francisco Abundez, William Angel, Victor Castro, Jose Escamilla, Jose Mejia, Nelson Portillo — *Lorton Stone, LLC*

Project: U.S. Capitol Building North Exterior Renovation - Washington, DC
Architect: Architect of the Capitol
General Contractor: Grunley Construction Company

★ **Jose Alvarez, Mauricio Bonilla, William Figueroa, Jose R. Lopez, Washington Martinez, Nelson Umana**
— *Lorton Stone, LLC*

Project: The National Gallery of Art - Work Area 9.1 & East Building Expansion - Washington, DC
Architect: Hartman-Cox Architects
General Contractor: The Whiting-Turner Contracting Company



INTERIOR STONE AND MARBLE

Fernando A. Barbosa, Howard S. Campbell, David C. Jonke, Christian B. Lancsa, Hector N. Mazariego, Santos V. Lopez
— *Rugo Stone, LLC*

Project: U.S. Diplomacy Center - Washington, DC
Architect: Beyer Blinder Belle
General Contractor: Gilbane Building Company

Mario D. Bardini, Keen Hoffman, David C. Jonke, Santos V. Lopez, Filipe P. Madureira, Franz R. Rojas
— *Rugo Stone, LLC*

Project: Trump International Hotel at the Old Post Office - Washington, DC
Architect: WDG Architecture, PLLC
General Contractor: Lendlease (US) Construction, Inc.

Michael Graves, David C. Jonke, Christian B. Lancsa, Santos V. Lopez, Zenon Moya, Matteo Randi
— *Rugo Stone, LLC*

Project: 1800 K Street - Washington, DC
Architect: VOA Architects
General Contractor: Forrester Construction

UNIT MASONRY

Pedro Cerrentino, Carols Cruz, Glenn Feldstein, Douglas Joya, Michael Pappas, Tranquilino Villegas
— *Telligent Masonry, LLC*

Project: Parc Meridian at Eisenhower Station - Alexandria, VA
Architect: Architects Collaborative, Inc.
Engineer: Cagley & Associates, Inc.
General Contractor: Paradigm Contractors, LLC

Dave Baker, Jose Gonzalez, Oscar Hernandez, Juan Lara, Carlos Moreno, Armando Pineda — *Calvert Masonry, Inc.*

Project: Metropolitan Park Phases 4/5 (The Bartlett) - Arlington, VA
Architect: Torti Gallas & Partners
General Contractor: Balfour Beatty Construction

Alex Campos, Celestino Campos, Edwin Cuadra, Miguel Cuadra, Robert McDuffie, Luis Rios
— *JPN Masonry, LLC*

Project: Lafayette Elementary School Design/Build Services - Washington, DC
Architect: Hartman-Cox Architects
General Contractor: Skanska USA Building, Inc.



MECHANICAL

HVAC-PIPING

Chris Bowker, Bruce Parker — *Joseph J. Magnolia, Inc.*

Project: Trump International Hotel at the Old Post Office - Washington, DC
Architect: WDG Architecture, PLLC
Engineer: Robert Silman Associates
General Contractor: Lendlease (US) Construction, Inc.

Jason Baker, Jason Coleman, Javier Hernandez, Anthony Holmes, Benjamin Turner, Robert Wilson
— *Dominion Mechanical Contractors, Inc.*

Project: George Washington University Science and Engineering Hall - 7th and 8th Floors Fit Out - Washington, DC
Architect/Engineer: Ballinger
General Contractor: Clark Construction Group, LLC

Jamie Daymude, Andy Greenleaf, Scott Horstkamp, Shuron Kearsy, Abu Mansaray, Raul Ramirez
— *Shapiro and Duncan, Inc.*

Project: American University Washington College of Law - Washington, DC
Architect/Engineer: SmithGroupJJR
General Contractor: The Whiting-Turner Contracting Company



*Mechanical: HVAC-Piping
American University Washington College of Law, Washington, DC*

Performance Mechanical Construction & Service



Dominion Mechanical Contractors is a privately owned full service contractor specializing in mechanical construction, service and repair, and design/build. This allows Dominion to service its customers for all of their mechanical needs from conceptual budgeting through mechanical construction, operation and maintenance.

DOMINION
M E C H A N I C A L

5265 Port Royal Rd, Ste.100
Springfield, VA 22151
Phone:(703)992-9588
info@dominionmc.com
www.dominionmc.com



Paul Chappelle, Paul Miller, Jason O'Brien, Michael See, Brady Strain, Joseph Wilson — *Limbach Company LLC*

Project: Cannon House Office Building
Renewal Phase O - Washington, DC

Architect: Shalom Baranes Associates

Engineer: James Posey Associates

General Contractor: Clark/Christman, A Joint Venture

Jeff Baxter, John Carter, Nick Lowe, Markus Lukas, Donnie Matthews, Chris Ott — *Shapiro and Duncan, Inc.*

Project: Confidential Client: Northern
Virginia Data Center - Sterling, VA

Architect: Corgan

Engineer: KW Mission Critical Engineering

General Contractor: HITT Contracting Inc.

HVAC-SHEET METAL

Robert Brinkley, Jovan Dendy, William Forney, Reginald Jackson, Nicholas Marfizo, Vernon Norman — *Norwood Environmental Systems*

Project: Washington Union Station Earthquake Remediation
- Bay 5 Ductwork Replacement - Washington, DC

Architects: Gensler/John Bowie Associates

Engineer: GHT Limited

Construction Manager: Jones Lang LaSalle

Todd Cooper, Fred Davis, Don Milam, Frank Roberts, Tony Stewart, Marcus Tongue — *I&B/Southland Industries*

Project: National Museum of African American
History and Culture - Washington, DC

Architects: Adjaye Associates/Davis Brody

Bond/Freelon/SmithGroup JJR

Structural Engineers: Guy Nordenson and

Associates/Robert Silman Associates

General Contractor: Clark/Smoot/Russell, a Joint Venture



METALS

MISCELLANEOUS METAL FABRICATION

Craftsmen — *American Iron Works, Inc.*

Project: National Museum of African American
History and Culture - Washington, DC

Architects: Adjaye Associates/Davis Brody

Bond/Freelon/SmithGroup JJR

Structural Engineers: Guy Nordenson and

Associates/Robert Silman Associates

General Contractor: Clark/Smoot/Russell, a Joint Venture



*Metals: Structural Steel Framing
1000 Wilson Boulevard
Rooftop Addition, Arlington, VA*



ORNAMENTAL METAL

Bill Bondura, Chris Bondura, Anthony Collicchio, Adam Kacperski, Jesse Marks, Anthony Orlando
— *Crescent Designed Metals*

Project: The National Gallery of Art - Work Area 9.1 & East Building Expansion - Washington, DC

Architect: Hartman-Cox Architects

Engineer: Thornton Tomasetti

General Contractor: The Whiting-Turner Contracting Company

Ruben Cano, Alexander Mendoz, Jose Muniz, Joel Perdomo, Darrell White, Scorpion's Welding — *Big D Metalworks*

Project: Sands Capital Management - Arlington, VA

Architect: OTJ Architects

Engineer: Thornton Tomasetti

General Contractor: DAVIS Construction

Lauren Pellerito, Jason Tucker, Allen Ward, Lawrence Welker III, Lawrence Welker IV, Randy Welker
— *Laran Bronze, Inc.*

Project: Holodomor Memorial - Washington, DC

Architect: Hartman-Cox Architects

Designer: The Kurylas Studio

General Contractor: Forrester Construction

STRUCTURAL STEEL FRAMING

Travis Burdett, Charles Crockett, Robert Harris, Michael Wilkinson — *Congressional Ironworks*

Project: 1000 Wilson Boulevard - Rooftop Addition - Arlington, VA

Architect: OTJ Architects

Engineer: Thornton Tomasetti

General Contractor: DAVIS Construction



SITWORK

LANDSCAPING

Brad Matthews — *Ruppert Landscape*

Project: National Museum of African American History and Culture - Washington, DC

Architects: Adjaye Associates/Davis Brody Bond/Freelon/SmithGroup JJR

Landscape Architect: Gustafson Guthrie Nichol

Civil Engineer: RK&K

Structural Engineers: Guy Nordenson and Associates/Robert Silman Associates

General Contractor: Clark/Smoot/Russell, a Joint Venture

UNDERPINNING, FOUNDATIONS AND EXCAVATIONS

Hugh Campbell, Robert Mann, Ryan Noell, Robert Pashkevich, Scott Pashkevich, Kevin Randall
— *Clark Foundations, LLC*

Project: CSX Virginia Avenue Tunnel Reconstruction Project - Washington, DC

Architect: Parsons Transportation Group

General Contractor: Clark/Parsons, a Joint Venture

Ray Brady, Art Rhodes, Billy Rhodes, Jr., Ray Rhodes, Cornell Scott, Derek Shields
— *Berkel & Company Contractors, Inc.*

Project: Uline Arena/REI - Washington, DC

Architect: Antunovich Associates

Engineer: Tadjer Cohen Edelson Associates

General Contractor: DAVIS Construction

Marc Esser, Jr., Tim George, Orlando Guacheta, Melvin Maldonado, Patrick O'Dell, Brian Osbourn
— *Clark Foundations, LLC*

Project: National Law Enforcement Museum - Washington, DC

Architect: Davis Buckley Architects and Planners

Engineer: Spiegel, Zamecnik & Shah Inc.

General Contractor: Clark Construction Group, LLC



Sitework: Landscaping
National Museum of African American History and Culture - Washington, DC

Eric Henmueller, James Mathews, Noe Meza, Albert Pisaneschi, Joshua Raper, Sims (Bo) Rodden — *Schnabel Foundation Company*

Project: 99 M Street (Ballpark Square) - Washington, DC
Architect: Gensler
Engineer: SK&A Structural Engineers, PLLC
General Contractor: Skanska USA Building

★ **Hunter Dunn, Mark Dunn, Tony Franklin, Adam Pashkevich, Chris Pashkevich, Thomas Snowden** — *Clark Foundations, LLC*

Project: 655 New York Avenue - Washington, DC
Architect: Shalom Baranes Associates
Engineer: KCE Structural Engineers
General Contractor: DAVIS Construction

UTILITIES

Raul Lucero, Tim Paugh, Randy Schultz, Tito Vasquez, Adonis Villatoro, Mario Villatoro — *Anchor Construction Corporation*

Project: DC United Soccer Stadium Infrastructure - Washington, DC
Engineer of Record: McKissack & McKissack
General Contractor: WM Schlosser Company

Haze Buchanan, Hector Duarte, Pedro Henriquez, Jose Motto, Nelson Romero — *Clark Civil and Doug Koenig* — *Ferguson Enterprises, Inc.*

Project: CSX Virginia Avenue Tunnel Reconstruction Project - Washington, DC
Engineers: Wiles Mensch Corporation/Parsons Transportation Group, Inc.
General Contractor: Clark/Parsons, a Joint Venture



Ruben Antonio Garcia, Rudis Melgar, Noe Alexander Salinas Padilla, Marlon Guillen Ruiz, Franquis Villatoro, Martin Villatoro — *Anchor Construction Corporation*

Project: Pepco Waterfront Substation Conduit
Phase 1 - Washington, DC

Architect/Engineer: Pepco Holdings, Inc.

General Contractor: Anchor Construction Corporation



SPECIAL CONSTRUCTION

DEMOLITION

★ **Clint Filges, Chuck Grabner, Mike Orth, Ricky Shawley, Dave Thompson** — *Fay, an i+iconUSA Company*

Project: CSX Virginia Avenue Tunnel
Reconstruction Project - Washington, DC

Architect/Engineer: Parsons Transportation Group

General Contractor: Clark/Parsons, a Joint Venture

GFRC EXTERIOR TRIM

Jose Aguilar, Abraham Arevalo, Mario Escobar, Israel Miranda, Octavio Ortega, Juan Tobias
— *P & D Contractors, LLC*

Project: Lafayette Elementary School Design/
Build Services - Washington, DC

Design Architect: Hartman-Cox Architects

Associated Architect: Grimm and Parker Architects

Engineer: BEI Structural Engineers

General Contractor: Skanska USA Building, Inc.

GFRC AND WOOD GRILLS

Ruben Buenidas, Robert Troiano
— *Component Assembly Systems, Inc.*

and **James McCormack,
Vincent Nitopi** — *Drake Incorporated*

Project: National Museum of African American
History and Culture - Washington, DC

Architects: Adjaye Associates/Davis Brody
Bond/Freelon/SmithGroup JJR

Structural Engineers: Guy Nordenson and
Associates/Robert Silman Associates

General Contractor: Clark/Smoot/Russell, a Joint Venture

HISTORIC FACADE RECONSTRUCTION

★ **Benji Coffey, Greg Meyers, Paul Richardson,
Bill Suhrhoff, Greg Viccharelli, Dennis Wilson**
— *Scaffold Resource, LLC*

Project: Revitalization of St. Elizabeth's
Center Building - Washington, DC

Architect: Shalom Baranes Associates

Engineer: Patuxent Engineering Group, LLC

General Contractor: Grunley Construction Company

SCAFFOLDING AND RIGGING

**Faustino Alvarado, Lisandro Arriola, Robert Born,
Tom McGonegal, Julio Vasquez** — *Safway Services*

Project: The Capitol Dome Restoration - Washington, DC

Architect: Architect of the Capitol

Engineer: Safway Services

General Contractor: Turner/Smoot, JV

THERMAL AND MOISTURE PROTECTION

**Nang Kim, Fernando Mendez, Phirum Mey, Sambath Suon,
Sotha Tim, Kim Ung** — *Prospect Waterproofing Company*

Project: Trump International Hotel at the
Old Post Office - Washington, DC

Architect: WDG Architecture, PLLC

Engineer: Trump International Hotel Washington

General Contractor: Lendlease (US) Construction, Inc.

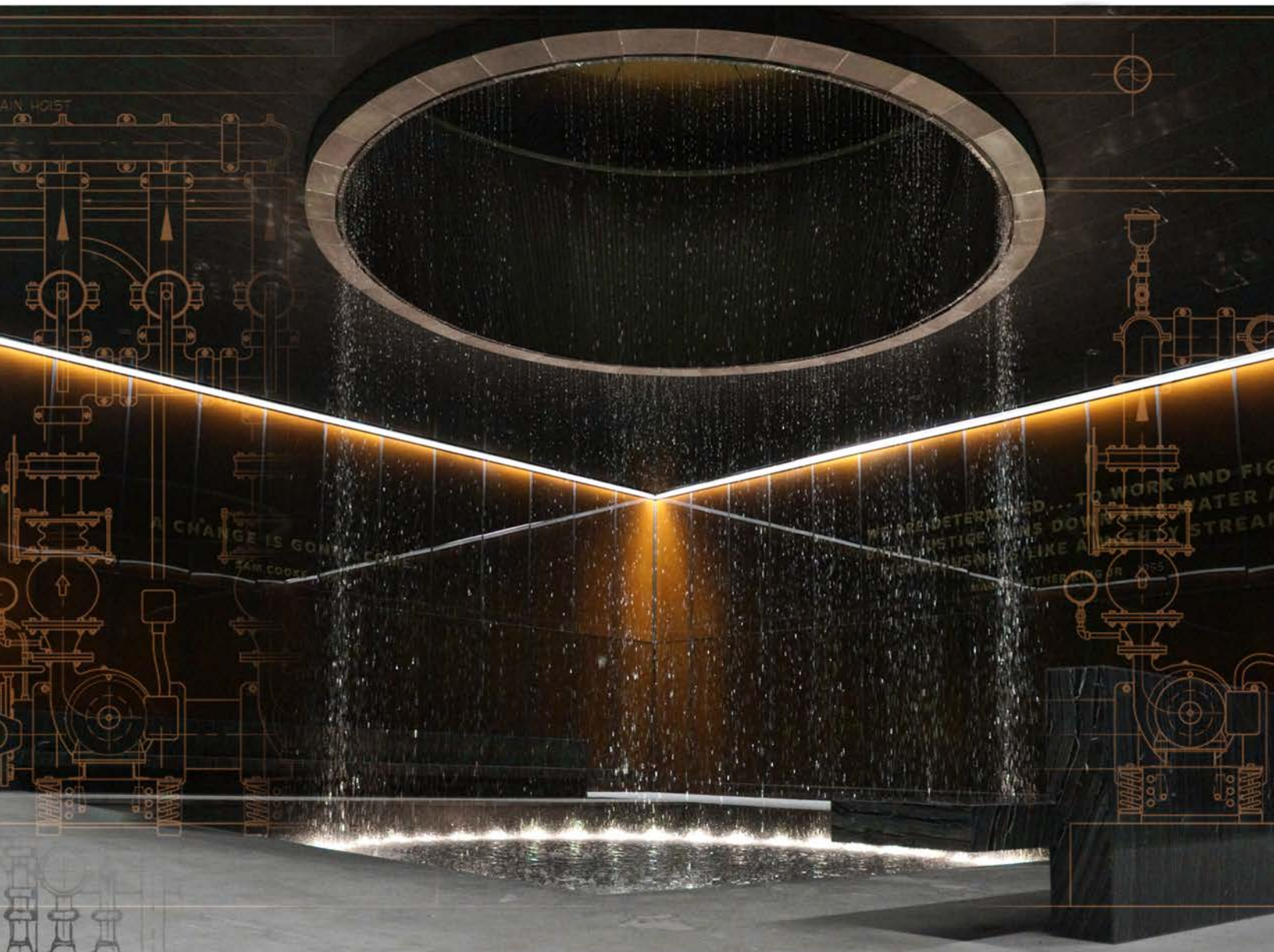

WESCO has joined Roman Fountains.

We're committed to making your vision come to life.

For over 50 years, we have provided the knowledge and expertise to bring your ideas to life; our combined team looks forward to bringing our experience to your next project.



Visit us at RomanFountains.com or call 877-794-1802



WATER FEATURE

★ **Ryan Coxy, Chris Roy, Kristina Solomon**
— *WESCO Fountains, Inc.*

Project: National Museum of African American History and Culture - Washington, DC
Architects: Adjaye Associates/Davis Brody Bond/Frelon/SmithGroup JJR
Structural Engineers: Guy Nordenson and Associates/Robert Silman Associates
General Contractor: Clark/Smoot/Russell, a Joint Venture

WOOD/METAL STAIRCASE

Ryan Carver, Alex Grace, Benjamin Graham-Putter, David Miller, Chris Pumphrey, Andrew Walker
— *Gutierrez Studios*

Project: Alarm.com Headquarters - McLean, VA
Architect: OTJ Architects
General Contractor: DPR Construction



WOODS & PLASTICS

ARCHITECTURAL MILLWORK

Keith Anderson, Paul Catena, Rodney Ferrifino, Andrew King, David Maldonado, Chuong Van Tran
— *Washington Woodworking Company*

Project: Bracewell - Washington, DC
Architect: Gensler
General Contractor: Harvey-Cleary Builders

Michael Do, Eduardo Howell-Gaskin, Eric Russell, Andre' Scott, Shane Seremet, Samuel Taliaferro — *Baker & Kerr, Inc.*

Project: Sands Capital Management - Arlington, VA
Architect: OTJ Architects
General Contractor: DAVIS Construction

Mike Guthridge, Tuan Mai, Charles Neal, Richard Seliga, Paul Stidham, Paul Tessandori — *ibs Millwork Corporation*

Project: LiUNA Tenant Improvement - Washington, DC
Architect: Gensler
Engineer: GHT Limited
General Contractor: DAVIS Construction

Eric Eatman, Don Jackson, Hanh Nguyen, Dave Popish, Mike Pullen, Randy Tusing
— *Jefferson Millwork & Design, Inc.*

Project: Metropolitan Park Phases 4/5 (The Bartlett) - Arlington, VA
Architect: Torti Gallas & Partners
General Contractor: Balfour Beatty Construction

Donald Castro, Gary Gilbert, Mark Miller
— *Mortensen Woodwork*

Project: Hogan Lovells - Washington, DC
Architect: Gensler
General Contractor: DAVIS Construction

Archie Dodson, Carlos Gomez, Ray Holmes, Mahdi Norozi, Mark Sutphin, Hung Vo
— *Gaithersburg Cabinetry & Millwork*

Project: Pentagon Federal Credit Union - McLean, VA
Architect: Gensler
General Contractor: HITT Contracting Inc.

Mike Dziedzic, Luis Martinez, Wesley Morris, Marco Orgaz, Victor Quiorga, Vicente Rosales
— *Imperial Woodworking Company*

Project: Sidley Austin LLP - Washington, DC
Architect: Gensler
General Contractor: rand* construction corporation

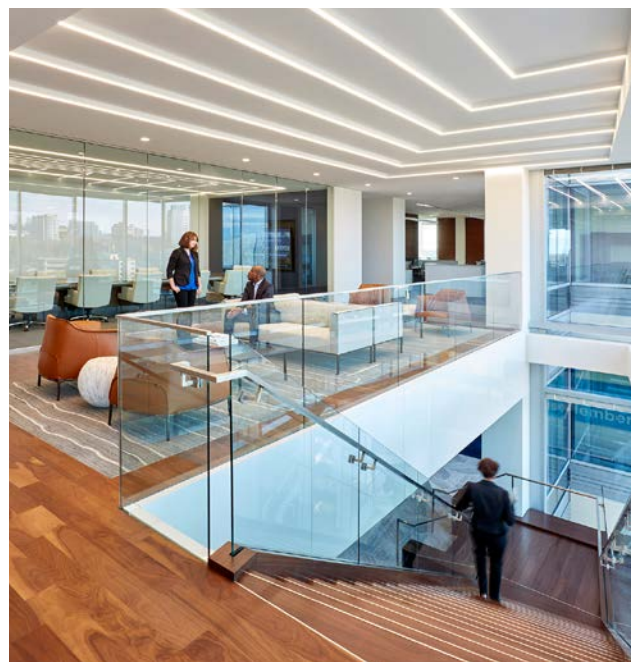

*Woods & Plastics: Architectural Millwork
Pentagon Federal Credit Union, McLean, VA*



A SPECIAL THANK YOU TO OUR 2017 CRAFTSMANSHIP AWARDS SPONSORS

CENTERPIECE SPONSOR

JE Richards Electric, Inc.

DESSERT SPONSOR

Dynalectric Company

WINE SPONSOR

Telligent Masonry, LLC

CRAFTSMEN GIFT SPONSORS

Clark Construction Group, LLC

IBEW Local Union 25

The Whiting-Turner Contracting Company

PLATINUM SPONSORS

Balfour Beatty Construction

Bricklayers and Allied Craftworkers Local 1 MD/VA/DC

Crescent Designed Metals

Dominion Mechanical Contractors, Inc.

Freestate Electrical Construction Company

GHT Limited

Hayles and Howe, Inc.

Joseph J. Magnolia, Inc.

Miller & Long Co., Inc.

Mona Electric Group, Inc.

R2L Architects/SK&A MD Structural Engineers

Singleton Electric Co., Inc.

Skanska USA Building, Inc.

Southland Industries

Turner/Smoot JV

Union Station Washington DC

GOLD SPONSORS

Cohen Seglias Pallas Greenhall & Furman PC

Custom Glass Services, Inc.

DAVIS Construction

DPR Construction

Fay, an i+iconUSA Company

Grunley Construction Company

The JBG Companies

Limbach Company, LLC

Peckar & Abramson, PC

PEPCO

Schnabel Foundation Company

Siemens Industry

VarcoMac Electrical Construction Co.

RECEPTION SPONSORS

Arban & Carosi, Inc.

ibs Millwork Corporation

Scaffold Resource, LLC

SILVER SPONSORS

Asmar, Schor & McKenna, PLLC

Fox Rothschild LLP

Rugo Stone, LLC

Varela, Lee, Metz & Guarino, LLP

BRONZE SPONSORS

Anchor Construction Corporation

Boston Properties

Transwall Office Systems, Inc.

2017 WBC CRAFTSMAN HALL OF FAME INDUCTEES

In Recognition of Extraordinary Dedication, Exceptional Skill, Quality Craftsmanship and Enduring Commitment. Congratulations to the 2017 Class of the Craftsman Hall of Fame



FERNANDO BARBOSA
MASONRY



JAMES QUINE
MECHANICAL



MARK VALENTINE
SPECIAL CONSTRUCTION

MEMBERS OF THE CRAFTSMAN HALL OF FAME

JOSE R. ABEIJON / WILLIAM BEATON / ROBERT B. BODMER / BERI BONACIC / RONALD BORZA, JR. / MARK D. BOUGHER
ROBERT E. BUNTING, III / VICTOR CASTRO / ANTHONY DAVIS / WILLIAM E. EATON / ROBERT GOTTLIED / HERMANN J. HAMBACH
RICHARD JOHNSON / FRANCISCO LORENZO / FRANCIS L. MARTIN / ALBERT "BUDDY" MCDOWELL, JR. / WILLIAM NOEL
FRANK ORREN / OVILA PAQUET / SCOTT PASHKEVICH / RALPH EUGENE PEARSON / WAYNE RADKE / EDELINE BUSH RHODES, III
JOE SIEIRO / KENNETH SPOHN / RICHARD F. STEVENS, JR. / REGIS J. STUDENY, JR. / WILLIAM SUHRHOFF / DAVID THOMAS
JOHN VENDEMIA / RONALD WONDOLOSKI / GERALD WHOLERY / FRED WISNER



2017 CRAFTSMANSHIP AWARDS JUDGES

Eric Anderson	Abe Espinal	Michael Kinkopf	Dan Ressler
Rachel Antonio	Tony Esteve	Lou Krupnick	Steve Robey
Roman Azizian	Pete Ewart	Adam Lackey	David Roccosalva
Joe Babarsky	Kent Fee	Jim Landoll	Stephanie Rochel
Kerric Baird	Jessie Ferrari	Oscar Lara	Shana Rothman
Andrew Barnor	Phil Fogarty	Jerry Lefever	Bobby Rozier
Becky Beach	Julie Forsht	Alfredo Llop	Ricky Scarlatella
Mark Belligham	Joe Fortino	Brian Lockwood	Jeff Schrock
Bill Bucco	Michael Frankowiak	Doug MacCall	Gayathri Shetty
Robyn Burrows	Teresa Frederick	William Magazine	Eunices Simon-Alexander
Alex Busch	Bob Frew	Jeremy Mahn	Dave Singleton
Jackie Cheron	Sarah Fudge	Ben Mahoney	Steve Smith
Darlene Chimaliro	Tim Garland	Mike Mallon	Daniel Smyser
Chuck Claar	Cindy Garrison	Bernie Marable	Cody Solberg
Larry Clark	Al Gaters	Cynthia Marks	Desh Sonyok
Greg Cobaugh	Charlene Gates	Leaha Martynuska	Rick Steele
Carolyn Cody Jones	Peter Ginzburg	Matt Matese	Tom Strandberg
Kris Collins	Steve Glass	Kelly McGuire	Eddy Stratton
Mike Conroy	Dave Goldberg	Tamara McNulty	Jim Sullivan
Gary Cooke	Nancy Gordon-Brooks	Wesley Meacombs	Chris Sychlový
Karen Cotton	Giacomo Goyzueta	Andrew Meyers	Emerson Teer
Luca Covi	Elaine Gray	Andy Miller	Scott Thomas
Lynne Coville	Chris Gregory	Tara Minner	Adrian Vaughan
Joe Curry	Steve Groth	Tyler Moyer	Jesse Wadeson
Joe Dabbs	Matt Hartman	Antoinette Myers	Steve Walker
Greg Dague	Chris Hartzler	Amy Navabi	Roy Wallace
Tyler Daley	George Hasser	Susan Nawrocki	Chuck Wallach
Joe Daly	Christine Heffernan	Ralph Neidert	Ed Weaver
Kelsey Daugherty	Sandy Henningsen	Ted O'Donnell	Matt Webber
Matt Daw	Dave Hofmann	John Odoriso	Allison White
Angel Diez	Emmillee Hogan	Rick Olcese	Ryan Whittier
David Dise	Alex Holcomb	Brent Paden	Thomas Wilson
Richard Douglas	Nick Holland	Scott Parr	Steve Wohlschlegel
Mark Drury	Frank Homer	Dave Pastrick	Charley Wooldridge
Edward Dudlik	Lee Hong	Greta Perry	Denis Xavier
David DuRant	Gabriel Jahn	Jim Polk	John Young
Karl Dzioba	Richard Jordan	Evan Prucha	
Ben Eitan	Elizabeth Justis	Tom Rathburn	
Susan Elliott	Erik Kaniecki	Josh Rauh	
Ken Ellis	Byron Kassing	Ross Rebraca	

For more banquet and project photography visit
www.flickr.com/photos/62695225@N02/albums/72157679149552104

2017 CRAFTSMANSHIP AWARDS



The background is a night-time aerial view of a city with illuminated buildings. Overlaid on this are several digital elements: a blue wireframe of a skyscraper on the right, a semi-transparent data dashboard on the left showing charts and graphs, and various icons (factory, CO2, lightning, Wi-Fi) connected by lines to the wireframe. Binary code (0s and 1s) is scattered across the scene.

SIEMENS

Ingenuity for life

When smarter buildings
drive smarter operations,
that's ingenuity for life.

Transparency is the key to greater energy and operational efficiency. Siemens Navigator powered by Sinalytics acquires and analyzes performance data for every building in your portfolio. The result: Comprehensive insights and powerful analytics combined in an easy-to-use cloud-based platform that tells you exactly what your building needs to deliver peak performance.

usa.siemens.com/navigator

VR and AR: What Do They Mean, and Why Do We Need Them?

By David Stone, Director of Virtual Construction, HITT Contracting, Inc.

Virtual reality (VR) allows us to immerse ourselves in a computer model and create a sense of presence that includes ability to look in all directions, move, and look above and under objects. It even allows us to interact with elements such as doors, equipment, etc. Some environments are conceptual in nature, and some are so real that it might be hard to distinguish virtual from reality. Drawbacks for VR include the need for a high-end computer graphics card, the need to be tethered to a computer (with a cable from headset to computer), and awareness of the real-world obstacles.

With augmented reality (AR) also referred to as mixed reality (MR), the real world meshes with the computer model. In other words, the AR device can map/understand the physical world around the user and project a computer model onto the real world in a way that appears to be anchored (or fit) in the real world. The result is a model/hologram that stays consistently in place relative to the movement of the AR device/user. Most AR devices such as HoloLens or Daqri operate in an independent device and hence are not tethered to a computer or power source. This offers significant benefits such as freedom of movement, but also lacks the horsepower required to create 'photo real' imagery or support large models.

While VR technology has existed for more than 20 years, it has only been in the last couple of years that VR has become consumer friendly with the advent of devices such as the Oculus Rift, HTC Vive, etc. In the past, the investment in this technology involved serious capital (\$100K and up). Today we can reasonably acquire VR tools for \$2,000 (headset plus computer).

In the AEC industry, we use VR in several applications. The most common use is visual communication of the design intent to stakeholders. While this may not seem like a new concept, it is a very different experience that, in many circumstances, allows stakeholders to experience the design in an immersive way and give feedback on needed changes prior to construction—saving them significant costs that are difficult to quantify but are very real.

Another way that the industry has adopted VR relates to safety training. VR allows a novice apprentice to experience real-world situations without the risk of injury, which is extremely valuable. Another area that is not strictly within the realm of AEC industry relates to the ability to take the typical web conference meeting and create more engaging interaction through shared VR experiences. What if your next conference room was completely virtual, the window view could be anywhere, design could be limitless, and the construction cost would be nothing... except for the computer model?

AR/MR are relatively new and have only been around for about 10 years. With technology improvements, many products

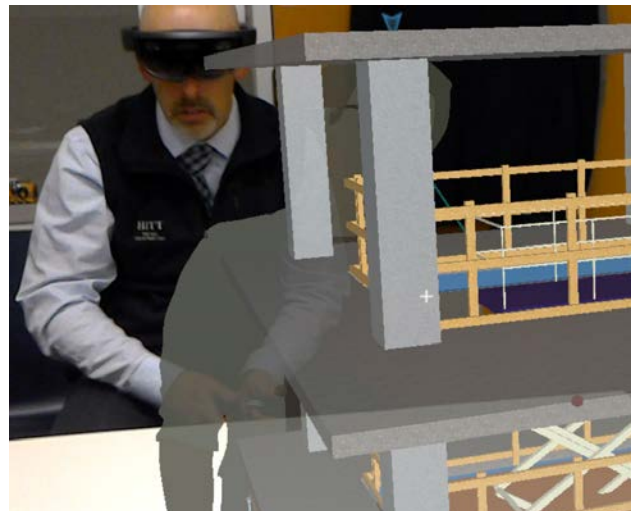

Technology and Innovation



are available now and more are coming out to the market in the next couple of years. Due to the ability to place models in the real environment at the correct scale and orientation, we can imagine a world that no longer needs to translate design models (or shop models) to 2D and then to 3D to construct in the field. Eliminating the bottleneck between the BIM world and the field can become reality. Instead of laying down a wall track by going back and forth to 2D drawings, the laborer can use the head-mounted device to trace the model view. The same concept applies to other disciplines and the role of quality control. Beyond the field implication, it can also give stakeholders the ability to spatially experience the design in the real world and make any modifications prior to construction.

At the moment we are still limited to the quality and size of models. But the biggest challenge that will need to be addressed is consistent and accurate placement or

synchronization of the MR model with the real world to allow acceptable construction tolerances to be achieved with relative ease. The other long-reaching implication of AR revolves around remote mentoring or training using basic applications like Skype to connect a junior field person with a senior manager to allow faster learning curve and reduce time waste.

Where is this all going? It is my observation that VR and AR/MR will most likely merge, or at least find common ground in the future as it relates to the devices we use, such as smartphones or headsets. AR/MR and a head-mounted device that is small enough and looks good (think Apple watchband concept in sunglasses frame) could become part of our everyday life, similarly to smartphones, in the next 3–5 years. Looking further into the future, there is speculation that these devices will be contact lenses. Our integration with AR/MR technology will augment the way we learn and improve our productivity while reducing risk and cost of doing business. **B**

Healthy Building Technology – NebuPure

By Morgan Renard, Operations Manager, SMNCR | Trifect

Occupant health and safety is the most important aspect of building management. Virus and bacterial infection specifically, carry an added psychological element that can result in millions of dollars in lost revenue through building closures, bad press and lawsuits. NebuPure is an innovative technology that focuses on addressing these potential threats.

The Technology

NebuPure is a small, powerful micro-aerosol generator that creates a dry fog to distribute a proprietary cleansing solution. Safe and effective, NebuPure technology can be easily deployed to provide a healthier and cleaner environment to key facilities, and can be used under an “on-site” manufacturing and treatment strategy.

The key technology in NebuPure has been safely and successfully tested by the U.S. Department of Energy and Department of Defense for more than 20 years, though the product has only recently made its way to the private sector. Besides extensive government and laboratory testing, NebuPure was field tested in athletic training facilities, mold remediation areas, hotel rooms and other enclosed spaces. All trials, verified by independent third parties, demonstrated 99.9999 percent or greater effectiveness against a variety of pathogens. This level of efficacy is achievable while remaining non-toxic to humans, animals and the environment.

Applications

The EPA's Indoor Air Study states that people spend 93% of their time indoors, 87% in buildings, 6% in vehicles and only the remaining 7% outdoors. The study indicates that indoor air pollutants are 2 to 5 times greater than outdoors and, in some instances, as much as a hundred fold. Indoor air quality has a huge effect on all of us. The Environmental Protection Agency has determined poor indoor air quality as the fourth biggest environmental threat in the United States.

Considering so much time is spent indoors, one of the applications we see with this technology is as an adjunct to building maintenance as a general disinfectant and indoor air quality enhancer. Potential facilities include:

- Hospitals and Clinics
- Sports Venues and Gymnasiums
- College Facilities and Classrooms
- Hotels and Resorts



Technology and Innovation

In addition to building maintenance, acute events such as mold remediation, trauma cleanup, drain backup disinfecting, and other situations where biological environmental controls are critical would greatly benefit from NebuPure application.

A lot of progress has been made towards improving the safety of our indoor environments. The LEED program and other initiatives continue to push the envelope, but many challenges still remain. At ServiceMaster NCR, we see NebuPure as yet another valuable technology that will bring us closer to safer, healthier buildings. **B**

For more details on NebuPure, please visit watertechholdings.com/nebupure



IS PROUD TO SUPPORT WBC AND ITS AWARD PARTICIPANTS

As one of the nation's largest MEP building systems experts, Southland Industries provides innovative yet practical solutions through a holistic approach to building performance. Specializing in engineering, construction, service, and energy needs, we optimize each stage of the building lifecycle with in-house expertise to improve the way buildings are designed, built, and maintained.

22340 DRESDEN STREET, SUITE 177
DULLES, VA 20166
+1. 703.834.5570 OFFICE
+1.800.613.6240 TOLL-FREE

southlandind.com

Advertise in the
Bulletin
Call (202) 293-5922
for more information

ConnectedSolutions



Member Projects



*Homewood Suites by Hilton, Arlington, VA
(project and project team)*

Donohoe Construction Company hosted a “Topping Out” celebration for the new **Homewood Suites by Hilton** project located at 1700 Lee Highway in Arlington, Va., in March. This event marks the building reaching its highest constructed point.

Developed by B.F. Saul Company, this all-suite, 11-story hotel will offer 168 keys featuring fully-equipped kitchens and separate living and sleeping areas that will accommodate both business travelers and tourists for extended stays. Amenities include a fitness facility, a 1,000-square-foot meeting room, a dining area and lobby bar, and two patios with fireplaces and outdoor grills. Two levels of above-grade parking with approximately 100 spaces will also be available to guests. Gordon & Greenberg Architects designed the hotel to achieve LEED Gold. The project broke ground



Member Projects



Brandywine Living at Alexandria, Alexandria, VA (project and project team)

June 2016 and is expected to reach substantial completion early next year.

Donohoe Construction Company also celebrated the topping out of the **Brandywine Living at Alexandria** project recently with a luncheon for project team members. Located in the new Cameron Park development on 450 South Pickett Street in Alexandria, the six-story senior living project is the first of five Brandywine Living communities planned in the Washington, DC area. The project broke ground March 2016 and is expected to be completed in December.

Designed by Niles Bolton & Associates to achieve LEED Silver Certification, Brandywine Living at Alexandria will consist of 116 luxury suites that are situated above ground-floor retail. The senior living community will feature 2 levels of below grade parking, interior and exterior courtyards, a therapy pool and gym, beauty salon, movie theater, pub, outdoor patios, private dining rooms and many other building amenities designed to enhance the quality of the resident experience. **B**



Fox Rothschild LLP
ATTORNEYS AT LAW



**Experienced Construction
Litigation Attorneys and
Trusted Business Advisers in the
Private and Federal Arenas**

*Proud Sponsors of the
Washington Building Congress*

Reggie Jones
Construction Partner
Chair, Federal Government Contracts Practice
202.461.3111 | rjones@foxrothschild.com

Dirk Haire
Construction Partner
202.461.3114
dhaire@foxrothschild.com

Doug Hibshman
Construction Partner
202.461.3113
dhibshman@foxrothschild.com

Nick Solosky
Construction Partner
202.696.1460
nsolosky@foxrothschild.com

THE ANNUAL WBC
**GOLF
 OUTING**
 MONDAY, JUNE 12

- Lansdowne Jones
- Belmont
- Lansdowne Norman
 Leesburg, VA



Visit wbcnet.org
 to register and
 for sponsorship
 opportunities.

WE BUILD DC



Proudly Serving the Washington Building Congress!

www.tishmanconstruction.com

EXCELLENCE,
 OUR BEDROCK FOR SUCCESS

Our mission is to form

"Partnerships resulting in innovative, cost effective and quality construction, exceeding our customers' expectations in a safe environment."

Approved Contractor for:



"Anchor Construction Corporation is Happy to Support the Washington Building Congress"

- Florentino Gregorio
 President

Anchor Construction, a CBE, specializes in utility construction: water, storm, sewer, ductbank, and concrete flatwork restoration. Also, as a general contractor, we perform roadway and bridge construction. Anchor's capability and expertise allow us to build new infrastructure and rehabilitate existing infrastructures.

Offices in Washington, D.C. & Maryland
 Licenses in: VA, MD, DC, DE



2254 25th Place, N.E. Washington, D.C. 20018 | Phone: (202) 269-6694 | Fax: (202) 529-3144 | www.anchorconst.com

Member Projects

THE PRACTICE OF SOLUTIONS

Construction | Government Contracts
Real Estate Transactions

Ranked by **Chambers USA** as one
of the leading Construction law
firms in Washington, DC



ASMAR | SCHOR
MCKENNA

5335 Wisconsin Avenue, NW Suite 400
Washington, DC 20015
202-244-4264 ♦ www.asm-law.com

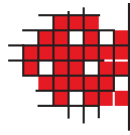

BOATMAN AND MAGNANI INC.
Award-winning Work Since 1960.

301.336.7700
600 Ritchie Road
Capitol Heights, MD 20743

MARBLE ■ STONE ■ TERRAZZO ■ MOSAICS
SLATE ■ GRANITE ■ CERAMIC TILE



ARCHITECTURAL WALL SYSTEMS

**Design assist contractor supporting the building envelope with
custom curtainwall and architectural wall systems**

7600-C Lindbergh Drive, Gaithersburg, MD 20879
301.417.1020 | www.teamppc.com



Keeping the legal side
of your industry
in perspective
while you soar
to new heights



BUILDING SOLUTIONS™

WATT TIEDER

WATT, TIEDER, HOFFAR & FITZGERALD, L.L.P.
www.watttieder.com



Kalkreuth

Roofing and Sheet Metal

EXTERIOR ENVELOPE CONTRACTOR

301-418-6100 • WWW.KRSM.NET



ENGINEERING CONSULTING SERVICES

GEOTECHNICAL | ENVIRONMENTAL | CONSTRUCTION MATERIALS | FACILITIES

www.ecslimited.com

New Members

SteelFab, Inc.

101 W. Broad St., Suite 520

Falls Church, VA 22046

p: 730-538-2320

www.steelfab-inc.com

Representative: **Chris Gregory**

New Small Business Members

DLM Architectural Millwork

1735 Sal St.

Green Bay, WI 54305

p: 920-965-5163

www.dlm-holdings.com

Representatives: **Mark Bair, Gary Langer**

Verity Commercial

1821 Michael Faraday Dr.

Reston, VA 20190

p: 703-435-4007

www.veritycommercial.com

Representatives: **Herman G. Diebler, Jr., Dave Miller**

Full Service Electrical Contractor Specializing in the Following Services:

- 24-hour Emergency Service
- Preventive Maintenance Services
- Infrared Thermography Scan
- Lighting Retrofits
- Estimating/Budget Services
- Mission Critical Facility Maintenance
- Service Contracts
- Generator/UPS Installations
- Design-Build/Assist Capabilities
- 3D Modeling
- Fire Alarm Tenant Fit-out
- Fire Alarm Retrofits of Existing Systems
- Fire Alarm/Sprinkler Testing & Service

Celebrating 50+ Years of Gold Standard Service!



22930 Shaw Road, Suite 100, Dulles, VA 20166

Call: 703-724-3500

Visit: www.dynalectric-dc.com

WCS CONSTRUCTION

BUILDING PARTNERSHIPS *EXCEEDING EXPECTATIONS*

www.wcsconstruction.com

Facebook icon | LinkedIn icon

New Government/ Institution Member

MCA of Metro Washington

4601 Presidents Dr., Suite 140
Lanham, MD 20706
p: 301-731-0330
www.mcamw.org
Representatives: **Thomas Bello,**
Hannah Inman

New Member Descriptions

DLM Architectural Millwork

DLM Architectural Millwork is a leading manufacturer of custom architectural millwork, commercial door jambs, and custom wood solutions for general contractors that specializes in medium- to large-scale remodeling and new construction projects. DLM distinguishes itself in the marketplace by its proven advantage of manufacturing excellence, project management, on-time delivery, and superior customer service. DLM Architectural Millwork is located in Green Bay, WI. The company has more than 40 skilled employees and over 65,000 square feet of dedicated manufacturing space.

MCA of Metro Washington

The **MCA of Metro Washington** is a membership organization of contractors who build and service plumbing, heating, ventilation, air conditioning and refrigeration systems in Washington, DC and its Virginia and Maryland suburbs. MCAMW is affiliated with the Mechanical Contractors Association of America.

SteelFab, Inc.

SteelFab is a leading AISC certified fabricator of structural steel in the United States.

Verity Commercial

Verity Commercial is a commercial real estate advisory and investment company located in Reston, VA. They bring extensive experience in brokerage, project management, and investment sales. Verity Commercial enables business owners and executives to transform real estate from a necessary business expense into a strategic business advantage. Verity simplifies complexity.



OWINGS, MD
P: 410.257.5225

BUTLER, PA
800.677.3815

WWW.KGE.COM

RELY ON OUR EXPERTISE



YOUR PREMIUM GENERATOR SUPPLIER

Generator & Transfer Switch Sales, Planned Maintenance Contracts, Generator Rentals, Replacement Parts, Load Banks, Service, Training.

Kelly Generator & Equipment, Inc. is a coordinated rapid response organization known for the quality of our service and the reliability of our generators. KG&E strives to provide our customers with quick and professional solutions to their electrical power needs. Ensure optimum quality in every product sold, professional, honest straight-forward relationships with our customers, and superior service for the life of our products.



Smart Field Service Solutions



Get peak performance from not only your field service workers, but also from your back-office and mid-office teams. With the Gomocha FMP360 toolkit, you'll have everything you need to deliver the right information to the right people—the first time and every time.

www.gomocha.com

2017 Annual Sponsors

CORPORATE SPONSOR



An Exelon Company

Pepco, a subsidiary of Exelon Corporation (NYSE: EXC), delivers safe, reliable electric service to more than 842,000 customers throughout Maryland and the District of Columbia.

STEEL SPONSORS



ALUMINUM SPONSORS



CONCRETE SPONSORS

Asmar, Schor & McKenna, PLLC
Black & Veatch
Boatman and Magnani, Inc.
Clark Construction Group, LLC
Cohen Seglias Pallas Greenhall & Furman PC
ECS Mid-Atlantic, LLC
EDG2, Inc.
Foulger-Pratt
Grunley Construction Company
Hensel Phelps

HITT Contracting Inc.
HSU Builders
Kalkreuth Roofing and Sheet Metal
PCC Construction Components
Peckar & Abramson, P.C.
RM Thornton Mechanical
Rosendin Electric, Inc.
Telligent Masonry, LLC
Watt, Tieder, Hoffar & Fitzgerald, PLLC
The Whiting-Turner Contracting Company

WBC Calendar & Advertising Information

Events Calendar

May 2017

- **May 24**, 5:00 – 7:00 p.m.
Spring Networking
Spider Kelly's, Arlington, VA

June 2017

- **June 12**
Golf Outing
Golf Club at Lansdowne and Belmont
Country Club
Leesburg, VA

- **June 15**, 4:00 – 6:00 p.m.
Small Business Networking
Meet the GC's
WBC Office
- **June 22**, 4:00 – 5:00 p.m.
Hammerheads Escape Room Live
Alexandria, VA
Limited to 40 attendees
- **June 22**, 5:00 – 7:00 p.m.
Hammerheads Networking
Light Horse
Alexandria, VA

August 2017

- **August 23**, 5:00 – 7:00 p.m.
Summer Networking
Cactus Cantina, Washington, DC

September 2017

- **September 28**
Fall Kickoff Bull & Oyster Roast

December 2017

- **December 12**
Holiday Party

The **Bulletin** covers issues of importance to the building industry, news about WBC members and information about upcoming events. The topics listed below will be covered as feature articles in upcoming issues of the **Bulletin**. Persons interested in contributing information or advertising should contact WBC before the 15th of the first month of each two-month issue (for example, content for the February/March issue would be due February 15th). The **Bulletin** is published six times a year by WBC. To place an ad, submit material or for more information call **(202) 293-5922**.

Editorial Calendar

December / January
Members Giving Back

February / March
Technology and Innovation

April / May
Craftsmanship Awards and
Hall of Fame

June / July
Rebuilding Together

August / September
Marketing & Business
Development

October / November
WBC Leadership & Committees

Ad Rates

	1 time	3 times	6 times
Member Rates:			
Black and White			
1/6 horizontal or 1/6 vertical	\$155	\$130	\$110
1/3 vertical or square	\$230	\$190	\$150
1/2 horizontal or vertical	\$430	\$350	\$290
Full-page	\$630	\$510	\$410
Color			
Inside Front Cover	\$730	\$590	\$480
Inside Back Cover	\$730	\$590	\$480
Back Cover	\$830	\$670	\$540

	1 time	3 times	6 times
Non-Member Rates:			
Black and White			
1/6 horizontal or 1/6 vertical	\$210	\$176	\$149
1/3 vertical or square	\$311	\$257	\$203
1/2 horizontal or vertical	\$581	\$473	\$392
Full-page	\$851	\$689	\$554
Color			
Inside Front Cover	\$986	\$797	\$648
Inside Back Cover	\$986	\$797	\$648
Back Cover	\$1,121	\$905	\$729

Magazine trim size: 8.5" w x 11" h | Live area: 8.375" w x 10.875" h

Ad Sizes

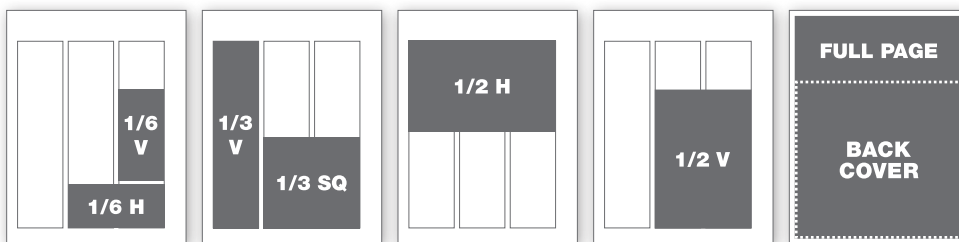

1/6 horizontal	4.43" w x 2" h
1/6 vertical	2.1" w x 4.2" h
1/3 square	4.43" w x 4.2" h
1/3 vertical	2.1" w x 8.6" h
1/2 horizontal	6.75" w x 4.2" h
1/2 vertical	4.43" w x 6.38" h
Back Cover	8.0" w x 7.5" h
Full-page	8.25" w x 10.75" h
Full-page + bleed	8.5" w x 11" h +125" bleed



1100 Vermont Avenue, NW
Suite 700
Washington, DC 20005
202-293-5922
www.wbcnet.org



Formulated for the **Future of Glass**

PPG's former flat glass business unit was acquired by Vitro Glass to form North America's largest glass producer. Now, with an exclusive focus on glass, we're making investments to expand capabilities and capacity. Yet, there are some things that won't change.

- **Same Products** from the **Same Plants**
- **Same Technology** and **Distribution**
- **Same People**

Vitro and PPG. The same, but better.

That's why we're Formulated for the Future of Glass.



Local contact and WBC member:
George Sultage
Senior National Architectural Manager
412-400-2920
gsultage@vitro.com



Vitro Architectural Glass
vitroglazings.com
1-855-VTRO-GLS (887-6457)

The PPG logo is a registered trademark of PPG Industries Ohio, Inc.